



## Cobalto™ C05300

On-Counter Omnidirectional Presentation Bar Code Scanner



Quick Reference Guide

## **Datalogic ADC, Inc.**

959 Terry Street  
Eugene, OR 97402  
USA

Telephone: (541) 683-5700

Fax: (541) 345-7140

©2014 Datalogic, Inc.

An Unpublished Work - All rights reserved. No part of the contents of this documentation or the procedures described therein may be reproduced or transmitted in any form or by any means without prior written permission of Datalogic ADC, Inc. or its subsidiaries or affiliates ("Datalogic" or "Datalogic ADC"). Owners of Datalogic products are hereby granted a non-exclusive, revocable license to reproduce and transmit this documentation for the purchaser's own internal business purposes. Purchaser shall not remove or alter any proprietary notices, including copyright notices, contained in this documentation and shall ensure that all notices appear on any reproductions of the documentation.

Should future revisions of this manual be published, you can acquire printed versions by contacting your Datalogic representative. Electronic versions may either be downloadable from the Datalogic website ([www.datalogic.com](http://www.datalogic.com)) or provided on appropriate media. If you visit our website and would like to make comments or suggestions about this or other Datalogic publications, please let us know via the "Contact Datalogic" page.

### **Disclaimer**

Datalogic has taken reasonable measures to provide information in this manual that is complete and accurate, however, Datalogic reserves the right to change any specification at any time without prior notice.

Datalogic and the Datalogic logo are registered trademarks of Datalogic S.p.A. in many countries, including the U.S.A. and the E.U. All other brand and product names may be trademarks of their respective owners.

Cobalto is a trademark of Datalogic ADC S.r.l.

### **Patents**

See [www.patents.datalogic.com](http://www.patents.datalogic.com) for patent list.

This product is covered by one or more of the following patents:

Design patents: EP002437681; EP002498865

Utility patents: DE19882767T1; EP0789315B1; EP0895175B1; EP1112546B1; EP1771810B8; GB2346474B; GB2346475B;

US5992740; US6012639; US6129279; US6244510; US6305606; US6719201;

US7051940; US7059529; US7201322; US7204422.



## DATALOGIC ADC, INC. END USER LICENSE AGREEMENT

**Notice to End User:** The Datalogic Product you have acquired contains embedded Software, which is integral to the product's operation. This Software is being provided to you under license, subject to the terms and conditions of this Agreement. If you use the Datalogic Product, you will be deemed to have accepted the terms and conditions of this Agreement. If you do not intend to be bound to the terms of this Agreement, Datalogic is not willing to license the Software to you, you may not use the Datalogic Product or the Software, and you must contact the party from whom you acquired the Datalogic Product for instructions.

This End User Software License Agreement ("Agreement") is a legally binding agreement governing the licensing of the Software and Documentation by Datalogic Holdings, Inc. and its subsidiaries and affiliates ("Datalogic") to the entity or person who has purchased or otherwise acquired a Datalogic Product ("End User"). For purposes of this Agreement, any software that is associated with a separate end-user license agreement is licensed to you under the terms of that license agreement. Datalogic and End User hereby agree as follows:

### 1. Definitions.

- 1.1 "Documentation" means materials such as user's guides, program reference guides, quick reference guides, manuals, or similar materials associated with or related to the Datalogic Product, whether in printed, "online", or other form.
- 1.2 "Proprietary Information" means: (a) source code, object code, software, documentation, and any related internal design, system design, data base design, algorithms, technology, technical data or information, implementation techniques, and trade secrets related to the Software, (b) any other trade secrets marked appropriately or identified as proprietary or confidential, and (c) any information that End User, under the circumstances, should recognize as confidential. Proprietary Information does not include any information that the receiving party can establish was (1) in the public domain, (2) already in the receiving party's possession or rightfully known prior to receipt, (3) rightfully learned from a third party not in violation of any other's proprietary rights, or (4) independently developed without access to Proprietary Information.
- 1.3 "Datalogic Product" means the Datalogic™ Cobalto™ product, including all embedded Software in and all Documentation related to such product, which has been purchased or otherwise acquired by End User, whether obtained directly or indirectly from Datalogic.
- 1.4 "Software" means any software or computer programs of Datalogic or its third party licensors in machine readable form which is embedded in the Datalogic Product, whether obtained directly or indirectly from Datalogic, including any replacement, update, upgrade, enhancement or modification.

### 2. Scope Of License Granted.

- 2.1 Datalogic grants to End User a non-exclusive, non-transferable, perpetual license to use the Software, solely on the Datalogic Product in which it is embedded ("designated Datalogic Product"), in machine-readable form only, solely for End User's internal business purposes. This Agreement does not convey ownership of the Software to End User. Title to the Software shall be and remain with Datalogic or the third party from whom Datalogic has obtained a licensed right. As used in this Agreement, the term "purchase" or its equivalents when applied to the Software shall mean "acquire under license." End User is not entitled to receipt or use of the source code to any Software.
- 2.2 End User shall not copy, modify, decompile, disassemble, reverse engineer, or otherwise reproduce or remanufacture the Software, whether modified or unmodified, nor sell, assign, sublicense, distribute, lend, rent, give, or otherwise transfer the Software to any other person or organization, for purposes other than as expressly provided in this Agreement, without Datalogic's prior written consent.

### 3. Transfers, Support.

- 3.1 Any copying, installing, reproduction, remanufacture, reverse engineering, electronic transfer, or other use of the Software on other than the designated Datalogic Product will be a material breach of this Agreement. However, Datalogic may elect not to terminate this Agreement or the granted licenses, but instead may elect to notify End User that End User is deemed to have ordered and accepted a license for each breaching use. End User shall pay Datalogic the applicable list price for such licenses as of the date of such breach.
- 3.2 End User shall not sell, assign, sublicense, distribute, lend, rent, give, or otherwise transfer the Datalogic Product to any third party unless such third party agrees with Datalogic in writing to be bound by the terms and conditions of this Agreement. Any such transfer of the Datalogic Product absent such agreement shall be null and void.

- 
- 3.3 End User may obtain support for Software from Datalogic at Datalogic's standard support fees and under Datalogic's standard support terms and conditions in effect at the time the support is requested.

#### **4. Intellectual Property.**

End User acknowledges that the Software constitutes valuable trade secrets of Datalogic or Datalogic's third party licensors and that the Software is protected by intellectual property laws and treaties. The license set forth in this Agreement does not transfer to End User any ownership of Datalogic's or its third party licensors' copyrights, patents, trademarks, service marks, trade secrets, or other intellectual property rights and End User shall have no right to commence any legal actions to obtain such rights. End User shall not remove, modify, or take any other action that would obscure any copyright, trademark, patent marking, or other intellectual property notices contained in or on the Datalogic Product.

#### **5. Proprietary Information.**

- 5.1 End User acknowledges that Proprietary Information is the confidential, proprietary, and trade secret property of Datalogic and Datalogic's third party licensors and End User acquires no right or interest in any Proprietary Information.
- 5.2 End User shall not disclose, provide, or otherwise make available the Proprietary Information of Datalogic or its third party licensors to any person other than End User's authorized employees or agents who are under confidentiality agreement, and End User shall not use the Proprietary Information other than in conjunction with use of the Datalogic Product exclusively for End User's internal business purposes. End User shall take steps to protect the Proprietary Information no less securely than if it were End User's own intellectual property.
- 5.3 The provisions of this Proprietary Information Section shall survive and continue for five (5) years after the termination of this Agreement.

#### **6. Limited Warranty.**

- 6.1 Datalogic warrants that, under normal use and operation, the Datalogic Product will conform substantially to the applicable Documentation for the period specified in the Documentation. During this period, for all reproducible nonconformities for which Datalogic has been given written notice, Datalogic will use commercially reasonable efforts to remedy nonconformities verified by Datalogic. End User agrees to supply Datalogic with all reasonably requested information and assistance necessary to help Datalogic in remedying such nonconformities. For all defects reported to Datalogic within the warranty period, Datalogic's liability is limited to providing End User with one copy of corrections or responding to End User's problem reports according to Datalogic's standard assistance practices. Datalogic does not warrant that the product will meet End User's requirements or that use of the product will be uninterrupted or error free, or that Datalogic's remedial efforts will correct any nonconformance. This limited warranty does not cover any product that has been subjected to damage or abuse, whether intentionally, accidentally, or by neglect, or to unauthorized repair or unauthorized installation, and shall be void if End User modifies the product, uses the product in any manner other than as established in the Documentation, or if End User breaches any of the provisions of this Agreement.
- 6.2 EXCEPT AS PROVIDED IN THIS AGREEMENT, THE DATALOGIC PRODUCT IS PROVIDED "AS IS" AND DATALOGIC MAKES NO WARRANTIES OF ANY KIND, EXPRESS OR IMPLIED, WRITTEN OR ORAL, WITH RESPECT TO THE PRODUCT, AND SPECIFICALLY DISCLAIMS THE IMPLIED WARRANTIES OF MERCHANTABILITY AND FITNESS FOR A PARTICULAR PURPOSE.

#### **7. Infringement.**

- 7.1 Datalogic will defend End User against any claim in a lawsuit that the Datalogic Product furnished hereunder directly infringe a United States patent or copyright of a third party and Datalogic will pay any damages finally awarded against End User by a court of competent jurisdiction that are attributable to such claim or will pay End User's part of any settlement that is attributable to such claim, provided, that 1) End User notifies Datalogic promptly in writing of the claim, 2) Datalogic controls the defense or settlement of the claim, and 3) End User cooperates fully with Datalogic in such defense or settlement. All notices of a claim should be sent to Datalogic Holdings, Inc., Legal Department, 959 Terry Street, Eugene, OR 97402.
- 7.2 In the defense or settlement of any such claim, Datalogic may, at its option, 1) procure for End User the right to continue using the Datalogic Product, 2) modify the Datalogic Product so that it becomes non-infringing, 3) replace the Datalogic Product with an equivalent product not subject to such claim, or 4) provide End User an opportunity to return the Datalogic Product and receive a refund of the purchase price paid, less a reasonable allowance for use.
- 7.3 Datalogic shall have no liability to End User for claims of infringement based upon 1) the use of any Datalogic Product in combination with any product which Datalogic has not either furnished or authorized for use with such Datalogic Product 2) the use of any Datalogic Product designed, manufactured, or modified to the specifications of End User, or 3) End User's modification of the Datalogic Product without written authorization from Data-

---

logic.

- 7.4 THE FOREGOING STATES DATALOGIC'S COMPLETE AND ENTIRE OBLIGATION CONCERNING CLAIMS OF PATENT, COPYRIGHT, OR OTHER INTELLECTUAL PROPERTY INFRINGEMENT, CANCELS AND SUPERSEDES ANY PRIOR AGREEMENTS, WHETHER ORAL OR WRITTEN, BETWEEN THE PARTIES CONCERNING SUCH CLAIMS, AND WILL NOT BE MODIFIED OR AMENDED BY ANY PAST, CONTEMPORANEOUS, OR FUTURE AGREEMENTS OR DEALINGS BETWEEN THE PARTIES, WHETHER ORAL OR WRITTEN, EXCEPT AS SET FORTH IN A FUTURE WRITING SIGNED BY BOTH PARTIES.

#### **8. Limitation Of Liability.**

EXCEPT AS PROVIDED IN SECTION 7, DATALOGIC SHALL NOT BE LIABLE FOR ANY CLAIMS AGAINST END USER BY ANY OTHER PARTY. IN NO EVENT SHALL DATALOGIC'S LIABILITY FOR DAMAGES, IF ANY, WHETHER BASED UPON CONTRACT, TORT (INCLUDING NEGLIGENCE), PRODUCT LIABILITY, STRICT LIABILITY, WARRANTY, OR ANY OTHER BASIS, EXCEED THE PRICE OR FEE PAID BY END USER FOR THE DATALOGIC PRODUCT. UNDER NO CIRCUMSTANCES SHALL DATALOGIC BE LIABLE TO END USER OR ANY THIRD PARTY FOR LOST PROFITS, LOST DATA, INTERRUPTION OF BUSINESS OR SERVICE, OR FOR ANY OTHER SPECIAL, CONSEQUENTIAL, CONTINGENT, INDIRECT, INCIDENTAL, PUNITIVE, EXEMPLARY, OR OTHER SIMILAR DAMAGES, EVEN IF DATALOGIC HAS BEEN ADVISED OF THE POSSIBILITY OF SUCH DAMAGES.

#### **9. Government Restricted Rights: International Use.**

- 9.1 Use, duplication, or disclosure of the Software by the U.S. Government is subject to the restrictions for computer software developed at private expense as set forth in the U.S. Federal Acquisition Regulations at FAR 52.227-14(g), or 52.227-19 or in the Rights in Technical Data and Computer Software clause at DFARS 252.227-7013(c)(1)(ii), whichever is applicable.
- 9.2 If End User is using the Datalogic Product outside of the United States, End User must comply with the applicable local laws of the country in which the Datalogic Product is used, with U.S. export control laws, and with the English language version of this Agreement. The provisions of the "United Nations Convention on International Sale of Goods" shall not apply to this Agreement.

#### **10. Termination.**

- 10.1 Either party may terminate this Agreement or any license granted under this Agreement at any time upon written notice if the other party breaches any provision of this Agreement.
- 10.2 Upon termination of this Agreement, End User immediately shall cease using any non-embedded software and shall return to Datalogic or destroy all non-embedded software covered by this Agreement, and shall furnish Datalogic with a certificate of compliance with this provision signed by an officer or authorized representative of End User. For embedded software, End User agrees to sign a waiver prepared by Datalogic concerning further use of the embedded Software. End User's resumed or continued use of the embedded Software after termination shall constitute End User's agreement to be bound by the terms and conditions of this Agreement for such use.

#### **11. General Provisions.**

- 11.1 Entire Agreement; Amendment. This document contains the entire agreement between the parties relating to the licensing of the Software and supersedes all prior or contemporaneous agreements, written or oral, between the parties concerning the licensing of the Software. This Agreement may not be changed, amended, or modified except by written document signed by Datalogic.
- 11.2 Notice. All notices required or authorized under this Agreement shall be given in writing, and shall be effective when received, with evidence of receipt. Notices to Datalogic shall be sent to the attention of Contract Administration, Datalogic Holdings, Inc., 959 Terry Street, Eugene, OR 97402, or such other address as may be specified by Datalogic in writing.
- 11.3 Waiver. A party's failure to enforce any of the terms and conditions of this Agreement shall not prevent the party's later enforcement of such terms and conditions.
- 11.4 Governing Law; Venue. This Agreement and the rights of the parties hereunder shall be governed by and construed in accordance with the laws of the State of Oregon U.S.A, without regard to the rules governing conflicts of law. The state or federal courts of the State of Oregon located in either Multnomah or Lane counties shall have exclusive jurisdiction over all matters regarding this Agreement, except that Datalogic shall have the right, at its absolute discretion, to initiate proceedings in the courts of any other state, country, or territory in which End User resides, or in which any of End User's assets are located.
- 11.5 Attorneys' Fees. In the event an action is brought to enforce the terms and conditions of this Agreement, the prevailing party shall be entitled to reasonable attorneys' fees, both at trial and on appeal.

- END -

## Software Product Policy

Datalogic reserves the right to ship its products with the latest version of software/firmware available. This provides our customers with the very latest in Datalogic software technology.

The only exception to this policy is when the buyer has a signed contract with Datalogic that clearly defines the terms and conditions for making software/firmware changes in products shipped to the buyer.

## Customers Under Software Support

Customers that elect to subscribe to Datalogic Software Maintenance and Support Agreement will receive 30 days advance notification of: (1) the release of a new software version; and/or (2) discontinuation of any prior software version that will no longer be supported. Datalogic will provide maintenance for a fee that will assist customers in transitioning to the next software version. If a customer is currently using the software version being discontinued, the customer may elect to transition to any one of the newer versions, depending on the hardware in use.

To arrange for a Software Maintenance and Support Agreement please contact your Datalogic sales person.



# Table of Contents

Software Product Policy .....	iv
Customers Under Software Support .....	iv
Operational Modes .....	1
Fixed Mode .....	1
Sweep Scanning .....	2
Presentation Scanning .....	2
Portable Mode .....	3
Targeted Handheld Scanning .....	3
Controls & Indicators .....	4
Touch Button .....	5
Visual Indicator .....	5
Speaker .....	5
Ring of Light .....	5
Setting Up the Scanner .....	6
Connecting / Disconnecting the Cable .....	6
Connecting to the Host Interface .....	7
Selecting the Interface Type .....	8
USB Interface .....	8
RS-232 Interface .....	9
Keyboard Wedge Interface .....	10
Keyboard Nationality .....	11
Country Mode .....	11
Programming .....	15
Restore Defaults .....	15
Resetting the Standard Product Defaults .....	15
Technical Features .....	16
Troubleshooting .....	17
Compliance .....	18
Regulatory Information .....	18
Statement of Agency Compliance .....	18
FCC Compliance .....	18
Canadian Notice .....	19
Power Supply .....	19
Scanner Labeling .....	19
China RoHS Table .....	20
WEEE Compliance .....	21
Warranty .....	22
Ergonomic Recommendations .....	23
Services and Support .....	24
Products .....	24
Service & Support .....	24
Contact Us .....	24

---

International Caution Statements .....	25
Class I .....	25





## Introduction

The Cobalto™ scanner (reader) delivers high performance in a small, fixed reader that can also be used as a targeted handheld scanner. Its innovative design maximizes productivity and minimizes operator stress, strain and fatigue.

## Operational Modes

The scanner can easily adapt to either fixed/portable or targeted handheld scanning applications. The front scan window, with its multi-line scan pattern, is used for most retail items. By touching the top button, the reader emits a single targeted scan pattern for handheld scanning of hard to read or bulky items, or to read an individual bar code among many bar codes.

### Fixed Mode

To use the scanner in Fixed Mode, seat it securely on the table. The reader can scan bar codes either in a Sweep or Presentation Mode to accommodate different user styles. To better adjust for your scanning needs, the scanner head can be tilted up or down.

**Figure 1. Scan Volume**

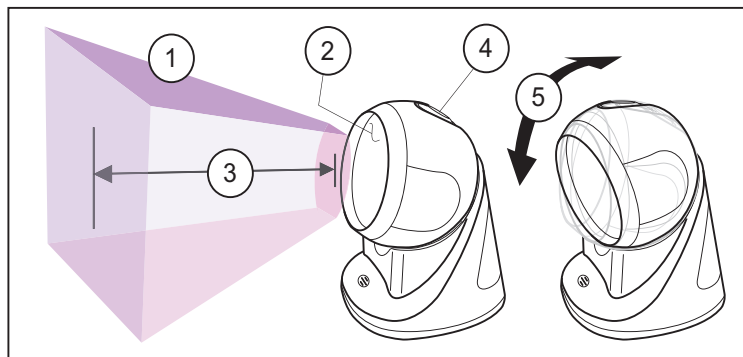

- |   |                             |   |                       |
|---|-----------------------------|---|-----------------------|
| 1 | Scan Volume                 | 4 | Touch Button          |
| 2 | Scan Window                 | 5 | Head tilts up or down |
| 3 | Scan Depth 5 to 55mm (5mil) |   |                       |

## Sweep Scanning

Move (sweep) the product, with the bar code facing the scan window. Optimal scanning distance is about 4.5 inches.

Figure 2. Sweep Motion

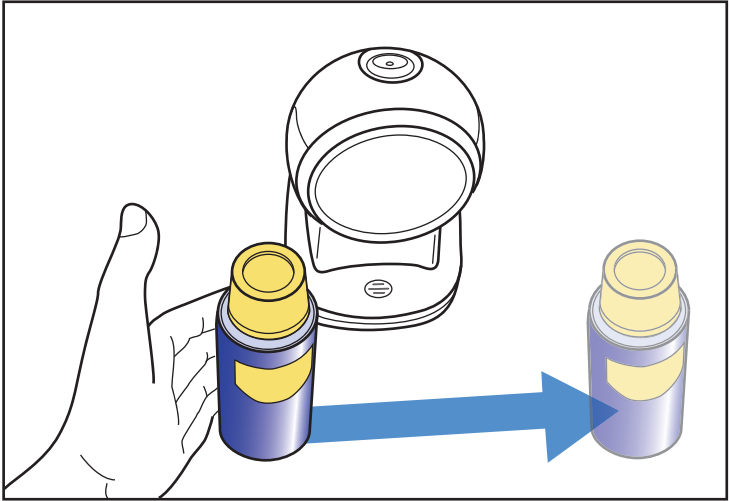

## Presentation Scanning

Face the bar code toward the center of the front scan window. Move the product with the bar code towards the scanner.

Figure 3. Presentation Motion

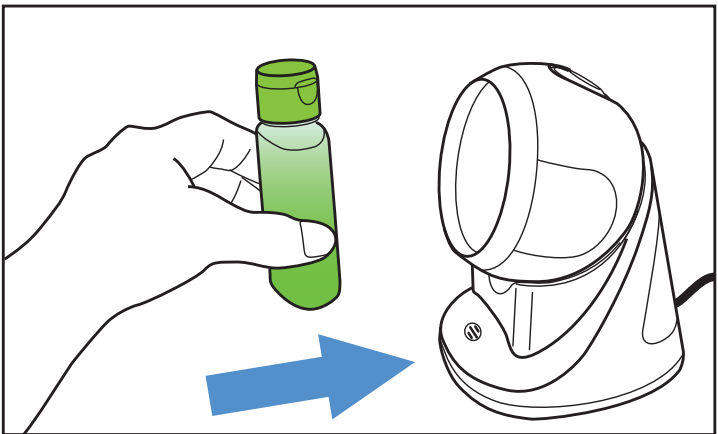

## Portable Mode

Take the scanner in your hand. Present (or sweep) the scanner to the bar code using the front scan window.

**Figure 4. Portable Mode Scanning**

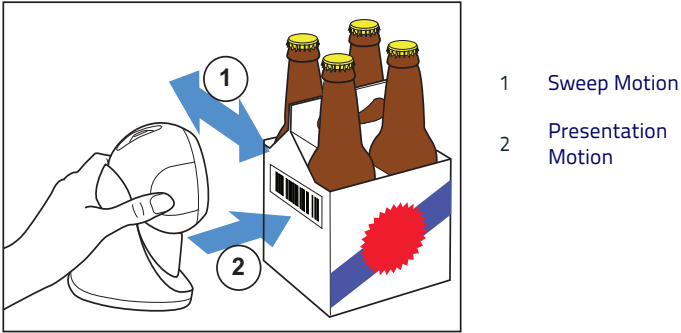

## Targeted Handheld Scanning

1. Take the scanner in your hand and touch the top button with the index finger to operate the single line functionality
2. Lift the reader and position the scan window over the product to be scanned.

**Figure 5. Targeted Handheld Scanning**

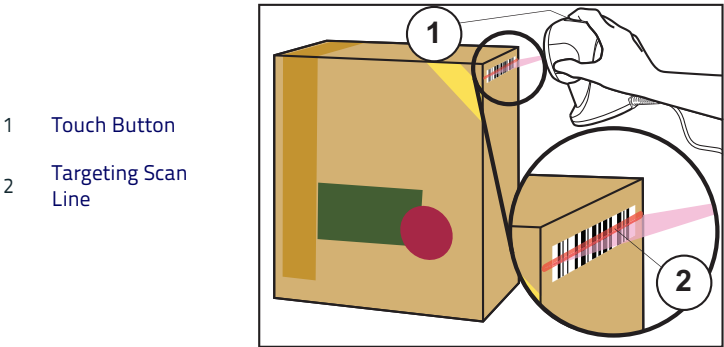

3. Center the single scan line on the bar code to maximize reading capability. Small bar code labels should be moved closer to the scan window, while larger labels need to be held at a further distance.
4. To continue scanning in Targeted Handheld Mode, just keep the top touch button pressed.

## Controls & Indicators

Figure 6 illustrates the locations of the scanner's features. Labels are shown here to illustrate their location only. Please view the labels on your product for actual details.

**Figure 6. Nomenclature and Labeling**

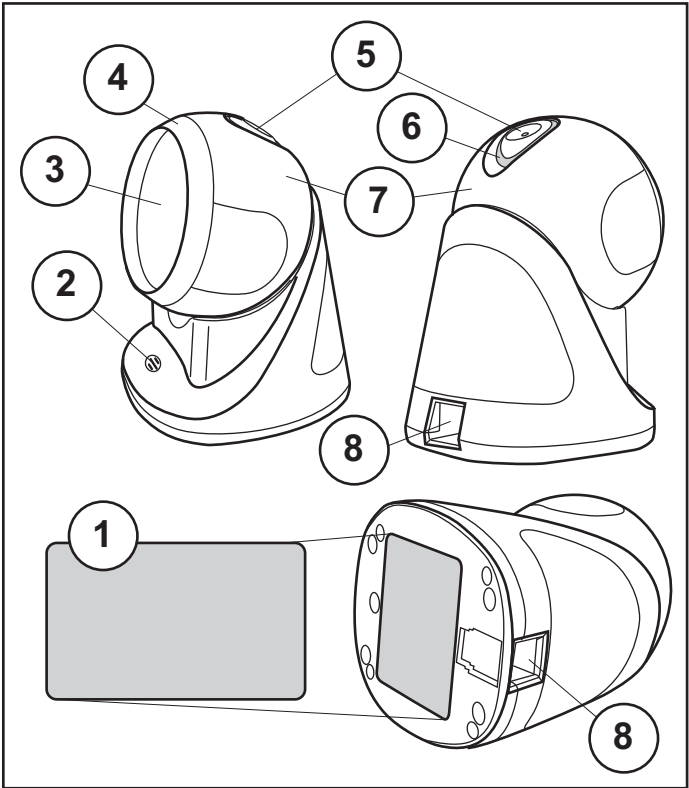

- |   |                                |   |                        |
|---|--------------------------------|---|------------------------|
| 1 | Serial Number/Regulatory Label | 5 | Touch Button           |
| 2 | Speaker                        | 6 | Visual Indicator       |
| 3 | Scan Window                    | 7 | Head                   |
| 4 | Ring of Light                  | 8 | Interface / Power Port |

## Touch Button

The touch button located on top of the head causes the scanner to enter Targeted Handheld Mode. In this mode, the reader scans bar codes with a single scan line. Releasing the touch button returns the scanner to the Fixed/ Portable Scanning Mode.

Pressing and releasing the touch button will also wake up the scanner, if it has entered Standby Mode, and return it to normal operation.

## Visual Indicator

The LED region encircling the touch button performs several indications:

- On blue – Indicates that the scanner is operational and ready to scan.
- Flashes once green when the scanner has read a bar code to indicate a successful read. This is usually accompanied by a good read tone (or ‘jingle’) from the speaker.
- When illumination turns off and the top green LED turns off, this indicates the scanner is in Standby Mode due to an extended period of inactivity.
- Flashing green repeatedly, accompanied by a series of tones indicates a failure has occurred. Contact your service personnel.

## Speaker

The speaker also indicates scanner functions:

- Normal Tone – A single tone when the scanner reads a bar code indicates a good read.
- Passed Selftest – A series of four tones are emitted when power is first applied to the scanner. This indicates the scanner passed the Selftest and is operating properly.
- Error Tone – The speaker sounds a series of tones alerting the operator of a possible system or component failure. If your scanner exhibits this behavior or behaves erratically, contact your service personnel.

## Ring of Light

The ring of light is illuminated with an attractive blue color during normal operation. It flashes green when the scanner has read a bar code, indicating a good read.

## Setting Up the Scanner

Follow the steps below to connect and get your scanner up and communicating with its host.

1. Connect the Cable to the scanner and the Host as shown in Figure 7.
2. Configure the Interface (see [Selecting the Interface Type](#) on page 8).
3. Program the scanner as needed using the configuration bar codes available in the PRG.

### Connecting / Disconnecting the Cable

Connect the cable at the scanner as shown in Figure 7. To release the cable upon disconnection, insert a bent paperclip into the opening shown, and push in gently to disengage the latch.

Figure 7. Cable Connection at the Scanner

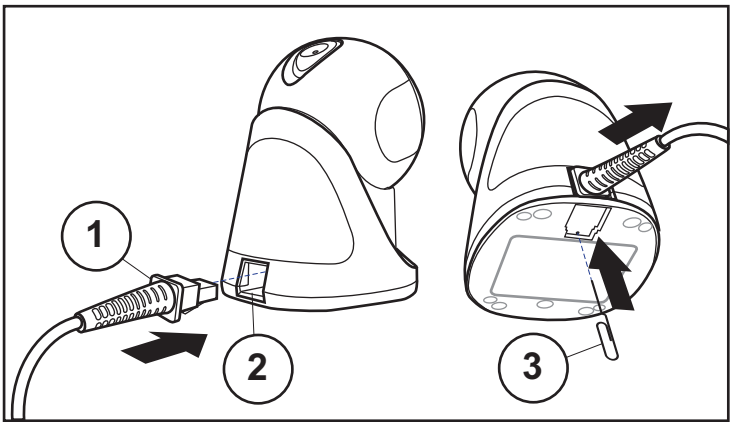

1 Cable Connector

3 Paperclip

2 Interface / Power Port

## Connecting to the Host Interface

The scanner is connected to the host interface in one of the following ways:

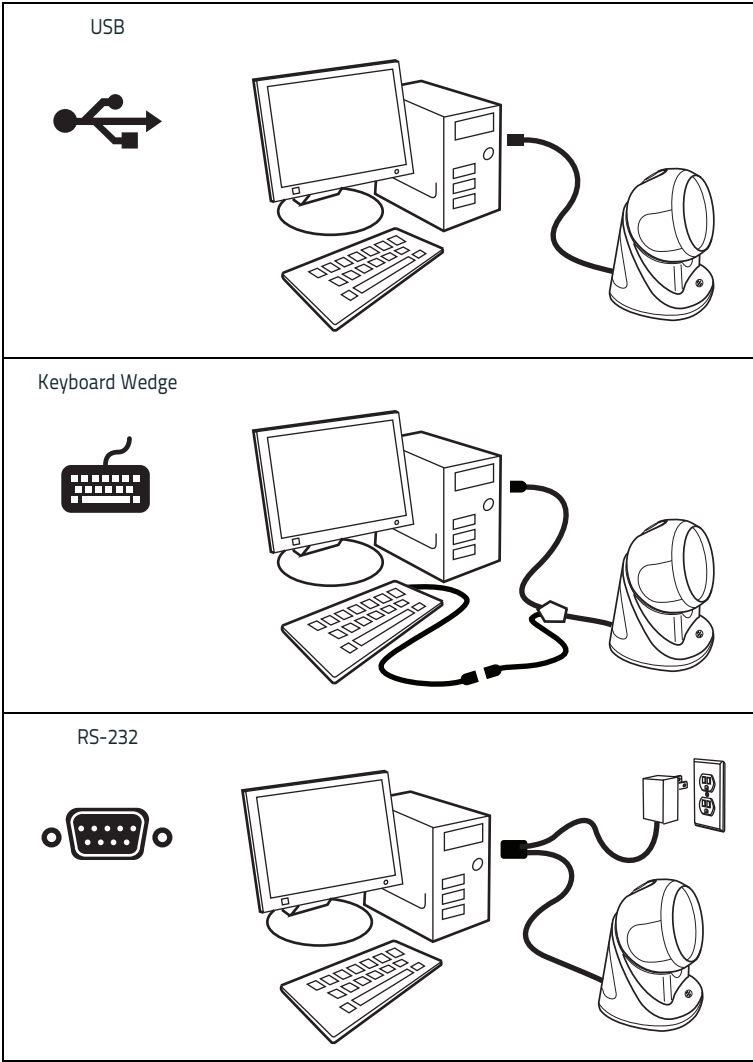

## Selecting the Interface Type

Upon completing the physical connection between the scanner and its host, proceed directly to Interface Selection below for information and programming for the interface type the scanner is connected to (for example: RS-232, Keyboard Wedge, USB, etc.) and scan the appropriate bar code to select your system's correct interface type, according to your application.

For additional interfaces other than those listed in this manual, see the Product Reference Guide (PRG) for this product, available online at [www.datalogic.com](http://www.datalogic.com).

### USB Interface

The scanner attaches directly to a USB host, or a powered USB hub, and is powered by it. No additional power supply is required. When using a USB interface, the scanner auto-detects the USB and defaults to the USB Keyboard interface.

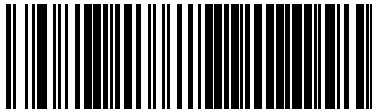

Select USB-COM-STD<sup>1</sup> (simulates RS-232 standard interface)



Select USB Keyboard (with standard key encoding)



Select USB Alternate Keyboard (with alternate key encoding)

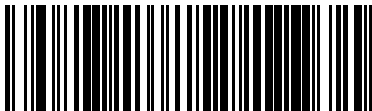

Select USB OEM

1. Download the correct USB Com driver from [www.datalogic.com](http://www.datalogic.com).



## USB Interface (continued)

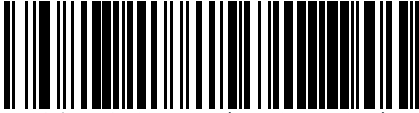

Select USB Composite (KEYBOARD + COM)

## RS-232 Interface

To use an RS-232 interface, scan the bar code for the desired RS-232 host type.



Select RS-232 Standard



Select RS-232 Wincor Nixdorf



Select RS-232 OPOS (for use with OPOS/UPOS/JavaPOS)

## Keyboard Wedge Interface

To use a Keyboard Wedge interface, scan the bar code for the desired keyboard type.

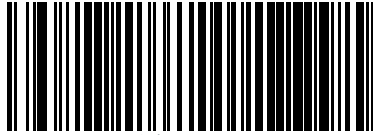

Select KBD-AT

(AT, PS/2 25-286, 30-286, 50, 50Z, 60, 70, 80, 90 & 95  
w/Standard Key Encoding)

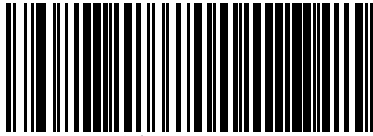

Select KBD-AT-NK

(IBM AT PS2 with standard key encoding but without external kbd.)

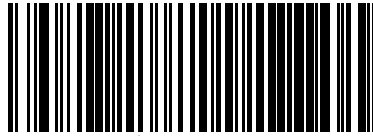

Select KBD-AT-ALT

(AT, PS/2 25-286, 30-286, 50, 50Z, 60, 70, 80, 90 & 95  
w/Alternate Key)

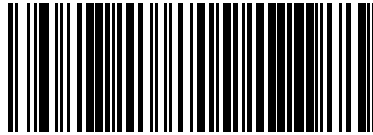

Select KBD-AT-ALT-NK (for IBM AT PS2 with alternate key  
encoding but without external keyboard)

## Keyboard Nationality

### Country Mode

This feature specifies the country/language supported by the keyboard. Only the following interfaces support ALL Country Modes.

- USB Keyboard (without alternate key encoding)
- AT, PS/2 25-286, 30-286, 50, 50Z, 60, 70, 80, 90 & 95 w/ Std Key Encoding
- Keyboard Wedge for IBM AT PS2 with standard key encoding but without external keyboard
- AT, PS/2 25-286, 30-286, 50, 50Z, 60, 70, 80, 90 & 95 without Alternate Key
- Keyboard Wedge for IBM AT PS2 without alternate key encoding but without external keyboard

All other interfaces support ONLY the following Country Modes: U.S., Belgium, Britain, France, Germany, Italy, Spain, Sweden.

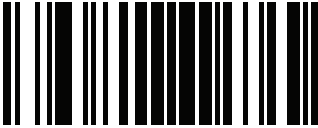
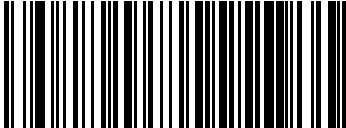
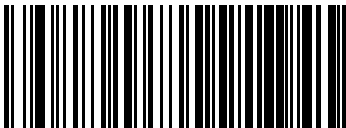
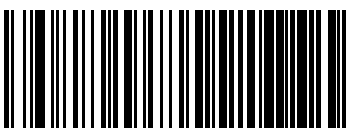
COUNTRY MODE
 ENTER/EXIT PROGRAMMING MODE
 Country Mode = U.S.
 Country Mode = Belgium
 Country Mode = Britain

<b>COUNTRY MODE (continued)</b>
 Country Mode = Croatia*
 Country Mode = Czech Republic*
 Country Mode = Denmark*
 Country Mode = France
 Country Mode = French Canadian
 Country Mode = Germany

\*Supports only the interfaces listed in the Country Mode feature description

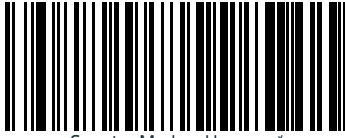
**COUNTRY MODE (continued)**

Country Mode = Hungary\*

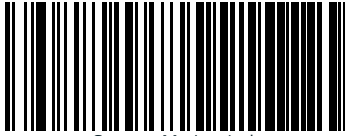

Country Mode = Italy

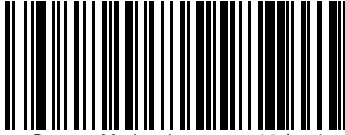

Country Mode = Japanese 106-key\*

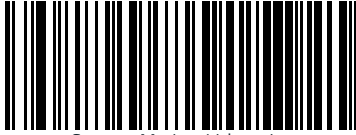

Country Mode = Lithuanian

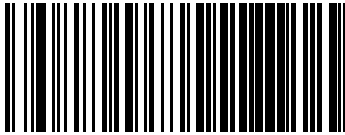

Country Mode = Norway\*

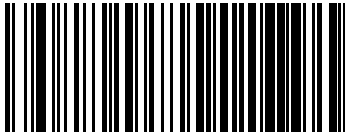

Country Mode = Poland\*

\*Supports only the interfaces listed in the Country Mode feature description

COUNTRY MODE (continued)
 <p>Country Mode = Portugal*</p>
 <p>Country Mode = Romania*</p>
 <p>Country Mode = Slovakia*</p>
 <p>Country Mode = Spain</p>
 <p>Country Mode = Sweden</p>
 <p>Country Mode = Switzerland*</p>

\*Supports only the interfaces listed in the Country Mode feature description

---

## Programming

The scanner is factory-configured with a set of standard default features. After scanning the interface bar code from the Interfaces section, select other options and customize your scanner through use of the programming bar codes available in the Product Reference Guide (PRG) for your model. Check the corresponding features section for your interface, and also the Data Editing and Symbologies chapters of the PRG.

### Restore Defaults

#### Resetting the Standard Product Defaults

If you aren't sure what programming options are in your scanner, or you've changed some options and want the factory settings restored, scan the Factory Default Settings bar code below. This will copy the factory configuration for the currently active interface to the current configuration.

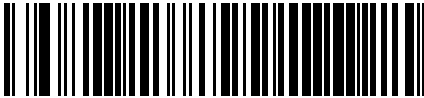

Factory Default Settings

To change the settings refer to the PRG.

## Technical Features

Item	Description
<b>Electrical Features</b>	
Power Supply RS-232 interface	5 Vdc $\pm$ 5%
Consumption:	Max operating current @ 5V: <500 mA Typical operating (changing colors) current @ 5V < 430 mA Standby mode/USB suspend < 2,5 mA
Max. Scan Rate	1500 lines/sec.
Reading Indicators	Ring of light and top indicator Illumination, Beep or jingle
<b>Optical and Read Performance</b>	
Ambient Light Immunity	Fluorescent, incandescent, mercury vapor and sodium vapor: 450 ft-candles (4,844 lux) Sunlight: 8,000 ft-candles (86,111 lux)
Motion Tolerance	On 100% EAN13 @ 10cm from nose: > 4 m/sec.
Scan Technology	Laser
Wavelength	650 nm
Laser Safety Class	Class 1 IEC 60825-1:2007
Reading Field	5 mils: 5 - 55 mm 100% EAN13: 0 to 275 mm
Max. Resolution	5 mils
PCS (Datalogic Test Chart)	35%
<b>Environmental Features</b>	
Working Temperature	0 °C to +40 °C (+32° to +104°F)
Storage Temperature	-40 °C to +70 °C (-40° to +158°F)
Humidity	90% non-condensing
Drop Resistance	1.2 m
ESD Protection	16 KV
Protection Class	IP30



Item	Description
<b>Mechanical Features</b>	
Weight (without cable)	445 g (15.7 oz)
Cable Length	2 m (6 ft 6 in)
Decode Capability	UPC/EAN, P2 /P5 add-ons; ISBN; ISSN; GTIN, add on 2/5/8; Codabar; Interleaved 2/5; Code 93; Code 128; Code 39; Code 32; Code 11; Industrial 2/5; IATA Industrial 2/5; EAN 128; Code 4; Code 5; Datalogic 2 of 5; Standard 2 of 5; MSI; Concatenated ISBT 128
Interfaces Supported	USB Interface (see page 8) RS-232 Interface (see page 9) Keyboard Wedge Interface (see page 10)

## Troubleshooting

Problem	Possible Cause	Possible Solutions
Nothing happens when the touch button is touched.	No power to the scanner.	Check system power. Ensure power supply is connected.
	Interface or power cables are loose.	Ensure all cable connections are secure.
Target beam comes on, but bar code does not decode.	Scanner not programmed for correct bar code type.	Ensure scanner is programmed to read the type of bar code scanned. Refer to the PRG for more information.
	Bar code label is unreadable.	Check the label to ensure it is not defaced. Try scanning another bar code type.
	Distance between reader and bar code is incorrect.	Move scanner closer to or further from the bar code.
Bar code is decoded but not transmitted to the host.	Reader not programmed for the correct host type.	Scan the appropriate host type bar code. Refer to the PRG for more information.



### NOTE

For detailed troubleshooting, refer to the PRG (Product Reference Guide)

## Compliance

See the section Laser Safety starting on page 25 for information about laser safety compliance.

### Regulatory Information

All models are designed to be compliant with rules and regulations in locations they are sold and will be labeled as required.

### Statement of Agency Compliance

This device complies with part 15 of the FCC Rules. Operation is subject to the following two conditions: (1) this device may not cause harmful interference, and (2) this device must accept any interference received, including interference that may cause undesired operation.

### FCC Compliance

The user is cautioned that changes or modifications not expressly approved by the part responsible for compliance could void the user's authority to use the equipment.

This equipment has been tested and found to comply with the limits for a Class B digital device, pursuant to part 15 of the FCC Rules. These limits are designed to provide reasonable protection against harmful interference in a residential installation. This equipment generates, uses, and can radiate radio frequency energy and, if not installed and used in accordance with the instructions, may cause harmful interference to radio communications. However, there is no guarantee that interference will not occur in a particular installation. If this equipment does cause harmful interference to radio or television reception, which can be determined by turning the equipment off and on, the user is encouraged to try to correct the interference by one or more of the following measures:

- Reorient or relocate the receiving antenna.
- Increase the separation between the equipment and receiver.
- Connect the equipment into an outlet on a circuit different from that to which the receiver is connected.
- Consult the dealer or an experienced radio or television technician for help.

## Canadian Notice

This equipment does not exceed the Class B limits for radio noise emissions as described in the Radio Interference Regulations of the Canadian Department of Communications.

Le présent appareil numérique n'émet pas de bruits radioélectriques dépassant les limites applicables aux appareils numériques de la classe B prescrites dans le Règlement sur le brouillage radioélectrique édicté par le ministère des Communications du Canada.



**Do not attempt to open or otherwise service any components in the optics cavity. Opening or servicing any part of the optics cavity by unauthorized personnel may violate laser safety regulations.**

## Power Supply

This device is intended to be connected to a UL Listed/CSA Certified computer which supplies power directly to the scanner or else be supplied by a UL Listed/CSA Certified Power Unit marked 'Class 2' or LPS power source rated 5.0 V, minimum 900 mA, which supplies power directly to the scanner via the power connector of the cable.



Atención

### Características de la fuente de alimentación eléctrica.

Entrada: 100 - 240 Vca  
 @ 350mA 50-60 Hz  
 Salida: máx 5.2 VDC, máx 2500mA  
 (-) Negativo al centro

Utilice en su red solo fuentes certificadas en Argentina.

El uso de fuentes de alimentación no compatibles puede resultar en riesgo de incendio o de choque eléctrico para el usuario.

## Scanner Labeling

See Figure 6 on page 4 for information about scanner labeling.

## China RoHS Table

## Cobalto™ C05300-XX

## China RoHS

PART	部件名称	Lead (Pb)	Mercury (Hg)	Cadmium (Cd)	Hexavalent Chromium (Cr(VI))	Polybrominated biphenyls (PBB)	Polybrominated diphenyl ethers (PBDE)
		有毒有害物质或元素					
Cable	电缆	铅	汞	镉	六价铬	多溴联苯	多溴二苯醚
Printed Circuit Board Assy	电路板组	X	○	○	○	○	○
Assembly, Module	光学组件	X	○	○	○	○	○
Power Supply	电源	X	○	○	○	○	○

**O:** 代表此种部件的所有均质材料中所含的该种有毒有害物质均低于中华人民共和国信息产业部所颁布的《电子信息产品中有毒有害物质的限量要求》(SJ/T 11363-2006) 规定的限量。

**X:** 代表此种部件所用的均质材料中,至少有一类材料其所含的有毒有害物质高于中华人民共和国信息产业部所颁布的《电子信息产品中有毒有害物质的限量要求》(SJ/T 11363-2006) 规定的限量

EFUP determined by "Look-up Method" (scanner). 环保使用期限取决于“查表法” (扫描仪)

## WEEE Compliance



### Waste Electrical and Electronic Equipment (WEEE) Statement

#### English

For information about the disposal of Waste Electrical and Electronic Equipment (WEEE), please refer to the website at [www.datalogic.com](http://www.datalogic.com).

#### Italian

Per informazioni sullo smaltimento delle apparecchiature elettriche ed elettroniche consultare il sito Web [www.datalogic.com](http://www.datalogic.com).

#### French

Pour toute information relative à l'élimination des déchets électroniques (WEEE), veuillez consulter le site Internet [www.datalogic.com](http://www.datalogic.com).

#### German

Informationen zur Entsorgung von Elektro- und Elektronik- Altgeräten (WEEE) erhalten Sie auf der Webseite [www.datalogic.com](http://www.datalogic.com).

#### Spanish

Si desea información acerca de los procedimientos para el desecho de los residuos del equipo eléctrico y electrónico (WEEE), visite la página Web [www.datalogic.com](http://www.datalogic.com).

#### Portuguese

Para informações sobre a disposição de Sucatagem de Equipamentos Eléctricos e Eletrônicos (WEEE - Waste Electrical and Electronic Equipment), consultar o site web [www.datalogic.com](http://www.datalogic.com).

#### Chinese

有关处理废弃电气电子设备 (WEEE) 的信息, 请参考 Datalogic 公司的网站: <http://www.datalogic.com/>。

#### Japanese

廃電気電子機器 (WEEE) の処理についての関連事項は Datalogic のサイト [www.datalogic.com](http://www.datalogic.com), をご参照下さい。

## Warranty

Datalogic warrants to Customer that Datalogic's products will be free from defects in materials and workmanship for a period of three (3) years from product shipment.

## Datalogic ADC Limited Factory Warranty

### Warranty Coverage

Datalogic ADC ("Datalogic") hardware products are warranted against defects in material and workmanship under normal and proper use. The liability of Datalogic under this warranty is limited to furnishing the labor and parts necessary to remedy any defect covered by this warranty and restore the product to its normal operating condition. Repair or replacement of product during the warranty does not extend the original warranty term. Products are sold on the basis of specifications applicable at the time of manufacture and Datalogic has no obligation to modify or update products once sold.

If Datalogic determines that a product has defects in material or workmanship, Datalogic shall, at its sole option repair or replace the product without additional charge for parts and labor, or credit or refund the defective products duly returned to Datalogic. To perform repairs, Datalogic may use new or reconditioned parts, components, subassemblies or products that have been tested as meeting applicable specifications for equivalent new material and products. Customer will allow Datalogic to scrap all parts removed from the repaired product. The warranty period shall extend from the date of shipment from Datalogic for the duration published by Datalogic for the product at the time of purchase (Warranty period). Datalogic warrants repaired hardware devices against defects in workmanship and materials on the repaired assembly for a 90 day period starting from the date of shipment of the repaired product from Datalogic or until the expiration of the original warranty period, whichever is longer. Datalogic does not guarantee, and it is not responsible for, the maintenance of, damage to, or loss of configurations, data, and applications on the repaired units and at its sole discretion can return the units in the "factory default" configuration or with any software or firmware update available at the time of the repair (other than the firmware or software installed during the manufacture of the product). Customer accepts responsibility to maintain a back up copy of its software and data.

### Warranty Claims Process

In order to obtain service under the Factory Warranty, Customer must notify Datalogic of the claimed defect before the expiration of the applicable Warranty period and obtain from Datalogic a return authorization number (RMA) for return of the product to a designated Datalogic service center. If Datalogic determines Customer's claim is valid, Datalogic will repair or replace product without additional charge for parts and labor. Customer shall be responsible for packaging and shipping the product to the designated Datalogic service center, with shipping charges prepaid. Datalogic shall pay for the return of the product to Customer if the shipment is to a location within the country in which the Datalogic service center is located. Customer shall be responsible for paying all shipping charges, duties, taxes, and any other charges for products returned to any other locations. Failure to follow the applicable RMA policy, may result in a processing fee. Customer shall be responsible for return shipment expenses for products which Datalogic, at its sole discretion, determines are not defective or eligible for warranty repair.

### Warranty Exclusions

The Datalogic Factory Warranty shall not apply to:

- (i) any product which has been damaged, modified, altered, repaired or upgraded by other than Datalogic service personnel or its authorized representatives;
- (ii) any claimed defect, failure or damage which Datalogic determines was caused by faulty operations, improper use, abuse, misuse, wear and tear, negligence, improper storage or use of parts or accessories not approved or supplied by Datalogic;
- (iii) any claimed defect or damage caused by the use of product with any other instrument, equipment or apparatus;

- (iv) any claimed defect or damage caused by the failure to provide proper maintenance, including but not limited to cleaning the upper window in accordance with product manual;
- (v) any defect or damage caused by natural or man-made disaster such as but not limited to fire, water damage, floods, other natural disasters, vandalism or abusive events that would cause internal and external component damage or destruction of the whole unit, consumable items;
- (vi) any damage or malfunctioning caused by non-restoring action as for example firmware or software upgrades, software or hardware reconfigurations etc.;
- (vii) the replacement of upper window/cartridge due to scratching, stains or other degradation and/or
- (viii) any consumable or equivalent (e.g., cables, power supply, batteries, keypads, touch screen, triggers etc.).

### No Assignment

Customer may not assign or otherwise transfer its rights or obligations under this warranty except to a purchaser or transferee of product. No attempted assignment or transfer in violation of this provision shall be valid or binding upon Datalogic.

DATALOGIC'S LIMITED WARRANTY IS IN LIEU OF ALL OTHER WARRANTIES, EXPRESS OR IMPLIED, ORAL OR WRITTEN, STATUTORY OR OTHERWISE, INCLUDING, WITHOUT LIMITATION, ANY IMPLIED WARRANTIES OF MERCHANTABILITY, FITNESS FOR A PARTICULAR PURPOSE, OR NONINFRINGEMENT. DATALOGIC SHALL NOT BE LIABLE FOR ANY DAMAGES SUSTAINED BY CUSTOMER ARISING FROM DELAYS IN THE REPLACEMENT OR REPAIR OF PRODUCTS UNDER THE ABOVE. THE REMEDY SET FORTH IN THIS WARRANTY STATEMENT IS THE CUSTOMER'S SOLE AND EXCLUSIVE REMEDY FOR WARRANTY CLAIMS. UNDER NO CIRCUMSTANCES WILL DATALOGIC BE LIABLE TO CUSTOMER OR ANY THIRD PARTY FOR ANY LOST PROFITS, OR ANY INCIDENTAL, CONSEQUENTIAL IN-DIRECT, SPECIAL OR CONTINGENT DAMAGES REGARDLESS OF WHETHER DATALOGIC HAD ADVANCE NOTICE OF THE POSSIBILITY OF SUCH DAMAGES.

### Risk of Loss

Customer shall bear risk of loss or damage for product in transit to Datalogic. Datalogic shall assume risk of loss or damage for product in Datalogic's possession. In the absence of specific written instructions for the return of product to Customer, Datalogic will select the carrier, but Datalogic shall not thereby assume any liability in connection with the return shipment.

## Ergonomic Recommendations



**CAUTION**

**In order to avoid or minimize the potential risk of ergonomic injury follow the recommendations below. Consult with your local Health & Safety Manager to ensure that you are adhering to your company's safety programs to prevent employee injury.**

- Reduce or eliminate repetitive motion
- Maintain a natural position
- Reduce or eliminate excessive force
- Keep objects that are used frequently within easy reach
- Perform tasks at correct heights
- Reduce or eliminate vibration
- Reduce or eliminate direct pressure
- Provide adjustable workstations

- Provide adequate clearance
- Provide a suitable working environment
- Improve work procedures.

## Services and Support

Datalogic provides several services as well as technical support through its website. Log on to [www.datalogic.com](http://www.datalogic.com) and click on the links indicated for further information.

## Products

Search through the links to arrive at your product page where you can download specific **Manuals** and **Software & Utilities**, including:

- **Datalogic Aladdin™**, a multi-platform utility program that allows device configuration using a PC. It provides RS-232 interface configuration as well as configuration bar code printing.

## Service & Support

- **Technical Support** - Product documentation and programming guides and Technical Support Department in the world
- **Service Programs** - Warranty Extensions and Maintenance Agreements
- **Repair Services** - Flat Rate Repairs and Return Material Authorization (RMA) Repairs
- **Downloads** – Manuals & Documentation, Data Sheets, Product Catalogs, etc.

## Contact Us

Information Request Form and Sales & Service Network.





## Laser Safety

### International Caution Statements

#### Class I

##### English

This scanner is certified in the U.S. to conform to the requirements of DHHS/CDRH 21CFR Subchapter J and to the requirements of IEC 60825-1:2007.

Class I and Class IIa products are not considered to be hazardous. The scanner contains internally a Visible Laser Diode (VLD) whose emissions do not exceed the maximum limits as set forth in the above regulations. The scanner is designed so that there is no human access to harmful laser light during normal operation, user maintenance or during prescribed service operations.

##### CAUTION

- Use of controls or adjustments or performance of procedures other than those specified herein may result in hazardous laser light.
- Do not attempt to open or otherwise service any component in the optics cavity. Opening or servicing any part of the optics cavity by unauthorized personnel may violate laser safety regulations. The optics system is a factory only repair item.
- Use of optical instruments with the scanner will increase eye hazard. Optical instruments include binoculars, microscopes and magnifying glasses. This does not include eye glasses worn by the user.

##### French

Ce scanner est certifié conforme à la norme DHHS/CDRH 21CFR sous-chapitre J et à la norme IEC 60825-1:2007.

Les produits de classe I et de classe II ne sont pas considérés dangereux. Le scanner contient une diode laser visible (VLD) dont les émissions ne dépassent pas les limites prescrites dans les normes précitées. Le scanneur est conçu de façon à ce qu'il ne soit pas possible d'accéder à la lumière laser pendant l'utilisation normale, l'entretien par l'utilisateur et les fonctions de maintenance prescrites.

##### ATTENTION

- L'utilisation de procédures de contrôle, réglage ou utilisation autres que celles spécifiées dans ce document peut entraîner une exposition dangereuse à la lumière du laser.
- Ne pas essayer d'ouvrir ni de réparer les composants de la cavité optique. L'ouverture ou la réparation d'une partie de la cavité optique par une personne non qualifiée peut entraîner la violation des règles de sécurité relatives au laser. Le système optique ne peut être réparé qu'en usine.
- Sont considérés comme instruments optiques les jumelles, les microscopes et les loupes. Les lunettes portées par l'utilisateur ne sont pas considérées comme tel.

##### German

Dieser Scanner ist den in den Vereinigten Staaten geltenden Vorschriften des DHHS/CDRH 21 CFR Subchapter J und den Vorschriften der IEC 60825-1:2007 entsprechend bescheinigt.

Produkte der Klasse I oder der Klasse II sind als ungefährlich eingestuft. Im Inneren des Scanners befindet sich eine VLD (Visible Laser Diode), deren Ausstrahlung die in den oben genannten Vorschriften angeführten Höchstgrenzen nicht überschreitet. Die Konstruktion des Scanners garantiert, daß bei normalem Betrieb, bei Wartung durch den Benutzer oder im Laufe planmäßiger Wartungsarbeiten kein Zugang zu schädlichem Laserlicht besteht.

##### VORSICHT

- Jegliche Anwendung von Streuungen, Reglern oder anderen Verfahren, die nicht in diesen Ausführungen erwähnt werden, können eine gefährliche Laserlichtbestrahlung zur Folge haben.

- Das optische System darf nur vom Werk repariert werden. Das Öffnen oder Warten von Bestandteilen des optischen Hohlraums durch unbefugtes Personal verletzt die Laser-Sicherheitsbestimmungen.
- Der Gebrauch von optischen Instrumenten zusammen mit dem Scanner steigert die Gefahr der Augenschädigung. Zu optischen Instrumenten gehören Ferngläser, Mikroskope und Lupen, aber nicht vom Benutzer getragene Brillengläser.

## Italian

È stato certificato che questo scanner si conforma ai requisiti della sezione J della normativa DHHS/CDRH 21CFR, e anche ai requisiti di IEC 60825-1:2007.

I prodotti di Classe I o Classe II non sono considerati pericolosi. Lo scanner contiene al suo interno un Visible Laser Diode (VLD), diodo laser visibile, le cui emissioni non eccedono i limiti stabiliti dalle normative sunnominate. Lo scanner è progettato in modo che non ci sia alcun accesso alla luce dannosa del laser nel corso di uso normale, di manutenzione da parte dell'utente o durante la manutenzione periodica stabilita.

### ATTENZIONE

- l'uso di comandi o di procedure diversi da quelli specificati in questa sede possono causare l'esposizione ad una luce laser pericolosa.
- evitare di tentare di aprire o riparare dei componenti nella cavità ottica. L'apertura o la riparazione della cavità ottica da parte di persone non autorizzate può essere in violazione dei regolamenti di sicurezza relativi all'impiego di raggi laser. Il sistema ottico può essere riparato soltanto in fabbrica.
- l'impiego di strumenti ottici assieme al lettore fa aumentare il rischio di danni alla vista. Il termine "strumenti ottici" sta ad indicare binocoli, microscopi o lenti d'ingrandimento, ma esclude eventuali occhiali da vista indossati dall'utilizzatore.

## Danish

Denne scanner opfylder de amerikanske krav stillet i "DHHS/CDRH 21CFR Subchapter J" og opfylder også de krav, der stilles i IEC 60825-1:2007.

Klasse I eller klasse II produkter anses for at være sikre. Scanneren indeholder en Visible Laser Diode (VLD), der ikke overskrider maksimumgrænserne, som beskrevet i ovenstående reglement. Scanneren er konstrueret, så der ikke er nogen menneskelig kontakt medskadelige niveauer af laserbestråling under normal brug, normal vedligeholdelse eller under foreskrevet servicering.

### ADVARSEL

- Udførsel af eftersyn eller justeringer eller anvendelse af andre procedurer end foreskrevet i vejledningen, kan medføre at man udsættes for skadeligt laser lys.
- Forsøg ikke at åbne eller på anden vis udføre service på komponenter i det optiske hulrum. Uautoriseret åbning eller service af dele af det optiske hulrum, kan betyde overtrædelse af Laser sikkerheds regulativerne. Det optiske system må kun repareres af fabrikken.
- Brug af optiske instrumenter med scanneren vil forøge faren for øjenbeskadigelser. Optiske instrumenter indbefatter kikkert, mikroskoper og forstørrelsesglas. Det indbefatter ikke briller båret af brugeren.

## Dutch

Deze scanner is in de V.S. goedgekeurd en voldoet aan de vereisten van DHHS/CDRH 21CFR Subchapter J een aan de vereisten van IEC 60825-1:2007.

Producten van klasse I (Class I) en klasse II (Class II) worden niet geacht gevaarlijk te zijn. De scanner bevat een inwendige Visible Laser Diode (VLD) waarvan de emissies de maximumgrenzen van bovenstaande reglementen niet overschrijden.

De scanner is zo ontworpen dat men bij normaal gebruik, onderhoud of tijdens het uitvoeren van de voorgeschreven onderhoudswerkzaamheden niet aan schadelijke niveaus wordt blootgesteld.

### WAARSCHUWING

- Men kan aan gevaarlijk laserlicht worden blootgesteld als de apparaten niet goed worden bediend of afgesteld, of als de procedures niet worden uitgevoerd zoals hierin beschreven staat.
- Probeer niet om onderdelen in de optica-ruimte te openen of er op enige wijze onderhoud aan uit te voeren. Openen of onderhoud van onderdelen van de opti-

caruimte door onbevoegd personeel kan in strijd zijn met de laser veiligheidsreglementen. Het opticasysteem mag alleen in de fabriek worden gerepareerd.

- Gebruik van optische instrumenten met de scanner vergroot het gevaar dat de ogen aan schadelijke niveaus van laserlicht worden blootgesteld. Optische instrumenten zijn onder meer verrekijkers, microscopen en vergrootglazen. Zo de gebruiker een bril draagt, valt die niet onder optische instrumenten.

## Swedish

Denna scanner uppfyller de amerikanska kraven DHHS/CDRH 21CFR Subchapter J samt kraven i IEC 60825-1:2007.

Produkter i Klass I (Class I) och Klass II (Class II) anses ej farliga. Scannern är utrustad med en intern, synlig laserdiod (Visible Laser Diode - VLD) vars emission inte överstiger max. värdena i ova stående säkerhetsföreskrifter. Scannern har konstruerats så att personer vid normal användning, bruksunderhåll och föreskriven service inte utsätts för skadlig laserstrålning.

### WARNING

- Om apparaten används på annat sätt än som specificerats i denna bruksanvisning kan användaren utsättas för farlig laserstrålning.
- Försök inte öppna eller reparera komponenter i den optiska kammaren. Om icke auktoriserad personal öppnar eller reparerar delar i den optiska kammaren, kan detta vara ett brott mot säkerhetsföreskrifterna för laserutrustning. Det optiska systemet får endast repareras i fabriken.
- Om optiska instrument används tillsammans med scannern ökar risken för ögonskador. Optiska instrument omfattar kikare, mikroskop och förstöringsglas. Glasögon som bärs av användaren omfattas ej av detta.

## Finnish

Tämä tutkain on hyväksytty Yhdysvalloissa vastaamaan DHHS/CDRH 21CFR Subchapter J luokka II ja 60825-1:2007 IEC-vaatimuksia.

Luokka I tai Luokka II tuotteiden ei katsota olevan vaarallisia. Tutkain sisältää sisäisen näkyvän laserdiodin (Visible Laser Diode (VLD)), jonka päästöt eivät ylitä yllä olevien säädösten asettamia maksimirajoja. Tutkain on suunniteltu siten, etteivät ihmiset altistu vaaralliselle lasersäteilylle normaalkäytön, käyttäjän suorittaman huollon tai ohjeiden mukaisten huoltoimenpiteiden aikana.

### VAROITUS

- Laitteen käyttö tai säätö muuten kuin näiden ohjeiden mukaan, voi aiheuttaa vaarallista laservaloa.
- Älä yritä avata tai muuten huoltaa mitään komponentteja optisessa osassa. Mikäli epäpätevä henkilö korjaa tai avaa jonkin komponentin optisessa osassa, voidaan tämän katsoa olevan rikkomus turvallisuusohjeita vastaan. Optinen systeemi on osa, joka voidaan korjata ainoastaan tehtaalla.
- Optisten laitteiden käyttö tutkaimen kanssa lisää silmien vaaraa. Optisiin laitteisiin kuuluu mm. kiikarit, mikroskoopit ja suurennuslasit. Käyttäjän silmälasit eivät kuulu näihin laitteisiin.

## Norwegian

Denne skanneren er godkjent i USA i samsvar med retningslinjene for DHHS/CDRH 21CFR, avsnitt J, og til IEC-kravene 60825-1:2007.

Produkter i klasse I eller klasse II ansees ikke som helsefarlige. Skanneren inneholder en innvendig, synlig laserdioder (VLD, Visible Laser Diode), som ikke overskrider maksimalgrensene som er fastsatt i retningslinjene ovenfor. Skanneren er konstruert, slik at personer ikke utsettes for farlige doser med laserstråler ved normal drift, brukers vedlikehold eller ved foreskrevet service.

### ADVARSEL

- Bruk av kontroller eller justeringer, eller utføring av andre prosedyrer enn de som er spesifisert her, kan føre til at man utsettes for livsfarlige laserstråler.
- Forsøk ikke å åpne eller på annen måte reparere komponenter i det optiske kammeret. Ingen del av det optiske kammeret må åpnes eller repareres av ikke-autorisert personale, da dette kan krenke forskrifter for sikker bruk av laserstråler. Det optiske systemet kan bare repareres på fabrikk.

- Bruk av optiske instrumenter sammen med skanneren øker mulighetene for øyenskade. Optiske instrumenter, omfatter kikkert, mikroskop og forstørrelsesglass. Vanlige briller regnes ikke med i denne kategorien.

## Portuguese

Este scanner foi certificado nos EUA para atender os requisitos do subcapítulo J do DHHS/CDRH 21 CFR e os requisitos do IEC 60825-1:2007.

Os produtos da Classe I ou Classe II não são considerados perigosos. O scanner contém internamente um Diodo de Laser Visível (VLD - Visible Laser Diode) cujas emissões não ultrapassam os limites definidos nos regulamentos mencionados acima. O scanner foi projetado de maneira que não exista acesso humano à luz de laser nociva durante a operação normal, manutenção pelo usuário ou durante as operações recomendadas de serviço.

### CUIDADO

- O uso de quaisquer controles, ajustes ou procedimentos além dos aqui especificados pode resultar em exposição perigosa à luz laser.
- Não tente abrir a cavidade ótica nem consertar, de forma alguma, qualquer de seus componentes. A abertura da cavidade ótica, ou o conserto de qualquer uma de suas peças por pessoal não autorizado poderá violar as normas de segurança do sistema de laser. O sistema ótico só poderá ser consertado pelo fabricante.
- O uso de instrumentos óticos com o scanner aumenta o perigo aos olhos. Instrumentos óticos incluem binóculos, microscópios e lentes de aumento. Estes não incluem os óculos do próprio usuário.

## Spanish

Este escáner está certificado en los EE.UU. porque reúne los requisitos DHHS/CDRH 21CFR Sección J y los requisitos de IEC 60825-1:2007.

Los productos de Clase I o Clase II no se consideran como peligrosos. El escáner tiene en su interior un Diodo Láser Visible (VLD) cuyas emisiones no exceden los límites máximos fijados en los reglamentos mencionados anteriormente. El escáner está diseñado de modo que las personas no tengan acceso a la luz láser peligrosa durante la operación normal, el mantenimiento por parte del usuario o durante las operaciones de servicio prescritas.

### PRECAUCIÓN

- el uso de controles o ajustes o la ejecución de procedimientos diferentes de los aquí especificados puede dar lugar a luz láser peligrosa.
- no trate de abrir o prestar servicio en forma alguna a ningún componente en la cavidad óptica. La apertura o reparación de cualquier parte de la cavidad óptica por personal no autorizado puede infringir las regulaciones de seguridad láser. El sistema óptico se puede reparar únicamente en la fábrica.
- el uso de instrumentos ópticos junto con el escáner, incrementará el daño visual. Los instrumentos ópticos incluyen los prismáticos, microscopios y lentes de aumento. Éstos no incluyen las gafas que lleve el usuario.

## Chinese

### 各国用户注意事项

本扫描器在美国获得认证，符合 **DHHS/CDRH 21CFR J** 分章规定的 **IIa** 级激光产品的要求。本产品也符合 **IEC 60825-1:2007** 规定的 **I** 级激光产品的要求。

**I** 级和 **IIa** 级激光产品均属于对人类无危害的产品。扫描器内有一个可见激光二极管(VLD)，它发出的辐射低于上述条例规定的最高限度。本扫描器经特别设计，在正常使用情况下，包括用户自行保养或进行规定的维修，人体均不会接触到有害的激光辐射。

#### 注意：

- 如果不按照规定的程序进行操作、控制或调节将可能产生有害的激光辐射。
- 请勿打开激光或检修激光发生器内的任何部件。未经授权的人员打开或修理激光发生器内部件可能违反激光安全条例。光学系统只可送交工厂修理。
- 使用扫描器时不得用其他光学仪器，否则会增加对眼睛的危害。这些光学仪器包括望远镜、显微镜和放大镜。但是，操作人员佩戴的眼镜不属于此范围。

## Japanese

本スキャナは米国においてDHHS/CDRH のJ項 Class II a レーザ製品規格の準拠品として、また **IEC 60825-1:2007** Class I レーザ製品規格の準拠品として認定されています。

Class I 及びClass II a 製品は「危険」とはみなされていません。本スキャナ内部には上記規格に定める最大値を超えない放射光量を持つ可視光レーザーダイオード(VLD)が使用されています。本スキャナは通常の運用、ユーザによる保守、所定の修理作業において有害なレーザー光が人体に影響を及ぼすことがないように設計されています。

#### 注意

- 本紙に書かれている手順以外の方法で本スキャナを制御・調整を行ったり、性能を超えた使い方をを行った場合には、レーザー光が危険となる場合があります。
- 所定の許可を得た人以外は本スキャナを開けたり、光学部の部品には手を触れないで下さい。レーザー安全規格に違反することになります。また光学部は工場でのみしか修理することができません。
- 光学機器を使用してスキャナ内部を覗くと、目に悪い影響を与えることがあります。光学機器には双眼鏡、顕微鏡、拡大鏡等が含まれますが、眼鏡はこれには該当しません。

## Hebrew

1 הודעות אזהרה בינלאומיות

עברית

הסורק הזה נושא אישור בארצות-הברית להיותו מתאים לדרישות של פרב 21 ירגב.דייג, פרק משני ש למוצרי לייזר מסוג שזו הסורק נושא גם אישור כמוצרי לייזר מסוג ז לדרישות של רכיב אלקטרוני מוכלל (בקו) 1-60825-2007.

מוצרי סוג ז או שז אינם נחשבים למסוכנים.

הסורק מכיל בתוכו דיודת לייזר נראית (גדה), אשר הקרינות שלה אינן עוברות את המידה המקסימלית המותרת כפי שכתוב בתקנות שלמעלה. הסורק מתוכנן בצורה כזו שאינה מאפשרת גישת אדם לאור הלייזר המזיק במהלך תפעיל נורמלי, במהלך טיפול תחזוקתי על-ידי המשתמש או במהלך תפעולי שירות קבועים.

אזהרה:

\* שימוש בבקרות או כיוונונים או ביצועי תהליכים מלבד אלו אשר מפורטים פה עלול לגרום לאור לייזר גורם-נוק.

\* אל תנסה לפתוח או לתת שירות לשום רכיבים בחלל האופטי. פתיחה או מתן שירות של איזשהו חלק בחלל האופטי על-ידי אדם בלתי-מוסמך עלול להפר את תקנות הבטיחות של הלייזר. המערכת האופטית היא פריט שנועד להיות מתוקן אך ורק על-ידי בית-החרושת.

\* השימוש במערכות אופטיות ביחד עם הסורק יגביר את הסיכון לעיניים. מכשירים אופטיים כוללים משקפות דו-עדשיות, מיקרוסקופים וזכוכיות-מגדלות. זה אינו כולל משקפי-ראייה שהמשתמש מרכיב.



Datalogic ADC Srl  
Via S. Vitalino, 13  
Lippo di Calderara di Reno (BO)  
40012 Italy

*La presente dichiarazione di conformità è rilasciata sotto la responsabilità esclusiva di Datalogic ADC Srl per:  
This Declaration of Conformity is issued under the sole responsibility of Datalogic ADC Srl for:  
Cette déclaration de conformité est établie sous la seule responsabilité de Datalogic Srl pour:  
Diese Konformitätserklärung wird unter der alleinigen Verantwortung des Datalogic ADC Srl erteilt für:  
Esta declaración de conformidad se expide bajo la exclusiva responsabilidad de Datalogic ADC Srl para:*

**C05330 ; Bar Code Reader**

*e tutti i suoi modelli  
and all its models  
et tous les modèles  
und seine modelle  
y todos sus modelos*

*sono conformi alle Direttive del Consiglio Europeo sottoelencate:  
are in conformity with the requirements of the European Council Directives listed below  
sont conformes aux spécifications des Directives de l'Union Européenne ci-dessous:  
den nachstehenden angeführten Direktiven des Europäischen Rats:  
cumple con los requisitos de las Directivas del Consejo Europeo, según la lista siguiente:*

## **2004/108/EC - EMC Directive 2011/65/EU – RoHS Directive**

*Basate sulle legislazioni degli Stati membri in relazione alla compatibilità elettromagnetica ed alla sicurezza dei prodotti.  
On the approximation of the laws of Member States relating to electromagnetic compatibility and product safety.  
Basée sur la législation des Etats membres relative à la compatibilité électromagnétique et à la sécurité des produits.  
Über die Annäherung der Gesetze der Mitgliedsstaaten in bezug auf elektromagnetische  
Verträglichkeit und Produktsicherheit entsprechen.  
Basado en la aproximación de las leyes de los Países Miembros respecto a la compatibilidad electromagnética y las  
Medidas de seguridad relativas al producto.*

*Questa dichiarazione è basata sulla conformità dei prodotti alle norme seguenti:  
This declaration is based upon compliance of the products to the following standards:  
Cette déclaration repose sur la conformité des produits aux normes suivantes:  
Diese Erklärung basiert darauf, daß das Produkt den folgenden Normen entspricht:  
Esta declaración se basa en el cumplimiento de los productos con las siguientes normas:*

**EN 55022 (CLASS B ITE ),  
DECEMBER 2010,  
EC: OCTOBER 2011:**

**LIMITS AND METHODS OF MEASUREMENTS OF RADIO  
DISTURBANCE CHARACTERISTICS OF INFORMATION  
TECHNOLOGY EQUIPMENT**

**EN 55024, NOVEMBER 2010:**

**INFORMATION TECHNOLOGY EQUIPMENT - IMMUNITY  
CHARACTERISTICS LIMITS AND METHODS OF MEASUREMENT**

**EN 50581, SEPTEMBER 2012:**

**TECHNICAL DOCUMENTATION FOR THE ASSESSMENT OF  
ELECTRICAL AND ELECTRONIC PRODUCTS WITH RESPECT TO  
THE RESTRICTION OF HAZARDOUS SUBSTANCES**

Lippo di Calderara,  
August 25th, 2014

Ruggero Cacioppo  
Quality & Reliability MGR- Europe

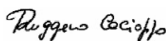



[www.datalogic.com](http://www.datalogic.com)

©2014 Datalogic, Inc. ■ All rights reserved.  
Datalogic and the Datalogic logo are registered trademarks of Datalogic S.p.A. in many countries, including the U.S.A. and the E.U.

**Datalogic ADC, Inc.**

959 Terry Street | Eugene | OR 97402 | USA

Telephone: (1) 541-683-5700 | Fax: (1) 541-345-7140

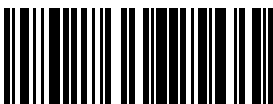

820065314 (Rev. A) Sept. 2014